

Tritax Symmetry (Hinckley) Limited

HINCKLEY NATIONAL RAIL FREIGHT INTERCHANGE

The Hinckley National Rail Freight Interchange Development Consent Order

Project reference TR050007

Sapcote Technical Note [Appendix 2 (A) - Sapcote Proposals Put Forward at DCO Stage]

Revision: 01

December 2024

Planning Act 2008

**The Infrastructure Planning (Applications: Prescribed Forms and Procedure) Regulations 2009
Regulation 5(2)(q)**

Appendix A Part 1 - General Arrangement Plan

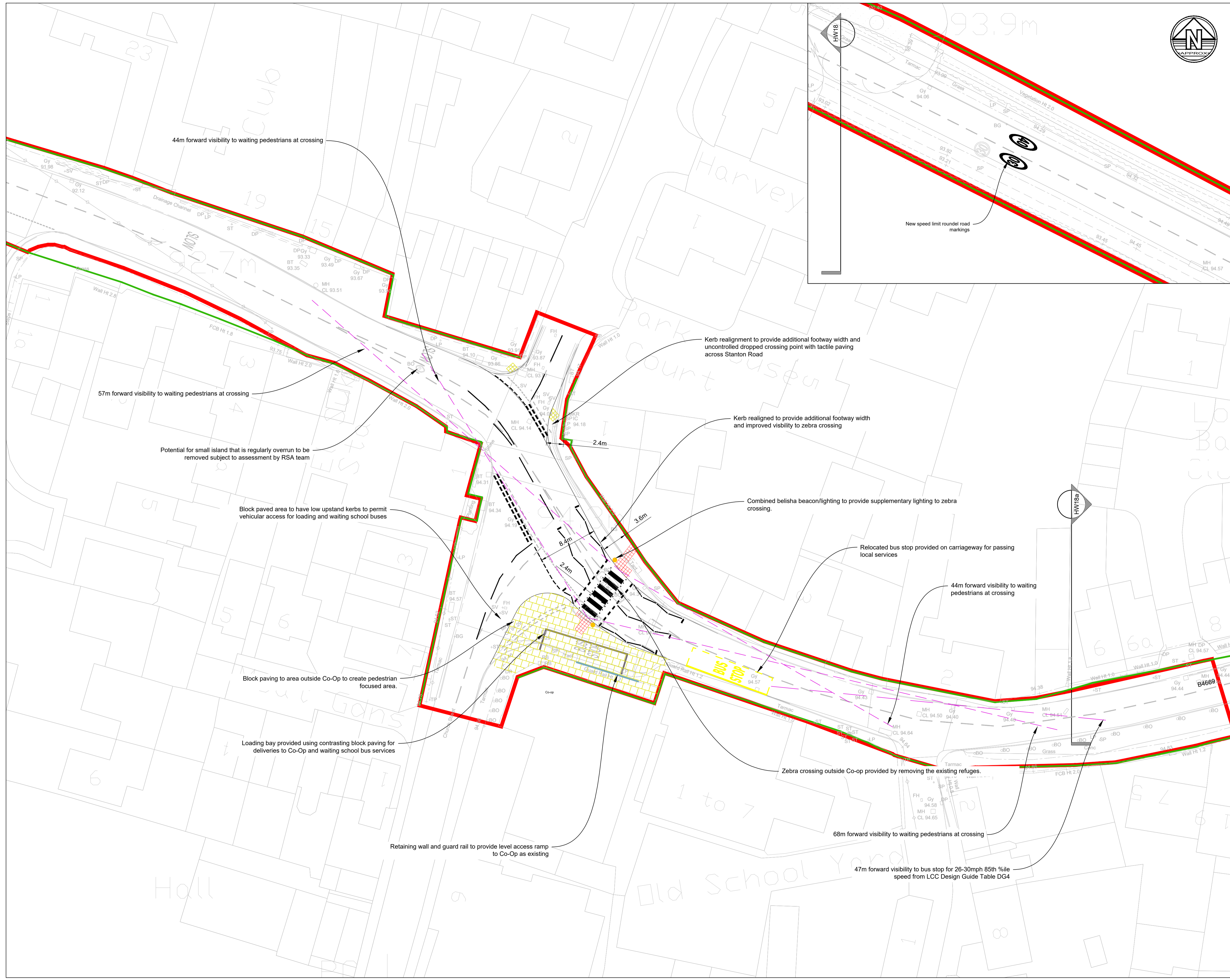

- Notes**
1. Do not scale from this drawing. All dimensions must be checked/verified on site. If in doubt, ask.
 2. This drawing is to be read in conjunction with all relevant architects, engineers and specialists drawings and specifications
 3. All dimensions in metres unless noted otherwise. All levels in metres unless noted otherwise
 4. Any discrepancies noted on site are to be reported to the engineer immediately
 5. For further details on specific areas of works, see the relevant SHW series drawings and appendices
 6. All works must be carried out to the requirements of the overseeing organisation.

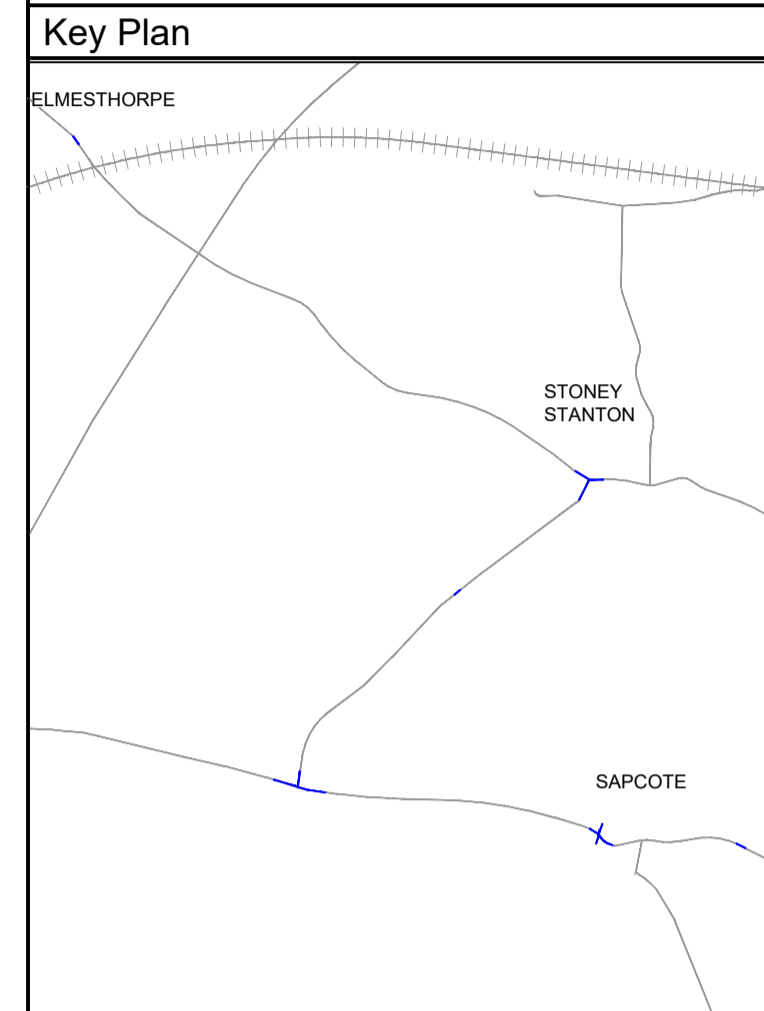

- Legend**
- Development Consent Order Limits
 - LCC Highway Boundary
 - NH Highway Boundary
 - Primary Signal Head
 - Secondary Signal head
 - Noise fence
 - Earthwork extents
 - Footway Type - Tactile paving in Red (R)
 - Footway Type - Tactile paving in Buff (B)

P02	04.01.23	Amended to suit topo survey	JM	SC
P01	10.11.23	Preliminary Issue	JM	SC
Rev	Date	Details of issue / revision	Dw	Rev

Issues & Revisions

BWB
A CAF GROUP COMPANY

- Birmingham | 0121 233 3322
- Leeds | 0113 233 8000
- London | 020 7407 3879
- Manchester | 0161 233 4260
- Nottingham | 0115 924 1100

www.bwbconsulting.com

TRITAX SYMMETRY
A TRITAX BIG BOX COMPANY

Project Title
HINKLEY NATIONAL RAIL FREIGHT INTERCHANGE

Drawing Title
GENERAL ARRANGEMENT SHEET 18

Drawn:	J.Manifold	Reviewed:	S.Carter
BWB Ref:	NTT2814	Date:	06.11.23
Scale@A1:	1:250	Status:	S2
Drawing Status:	PRELIMINARY	Rev:	P02
Project - Originator - Zone - Level - Type - Role - Number	HRF-BWB-HGN-HW18-DR-CH-0100		

Appendix A Part 2 - Vehicle Tracking Sheet 1

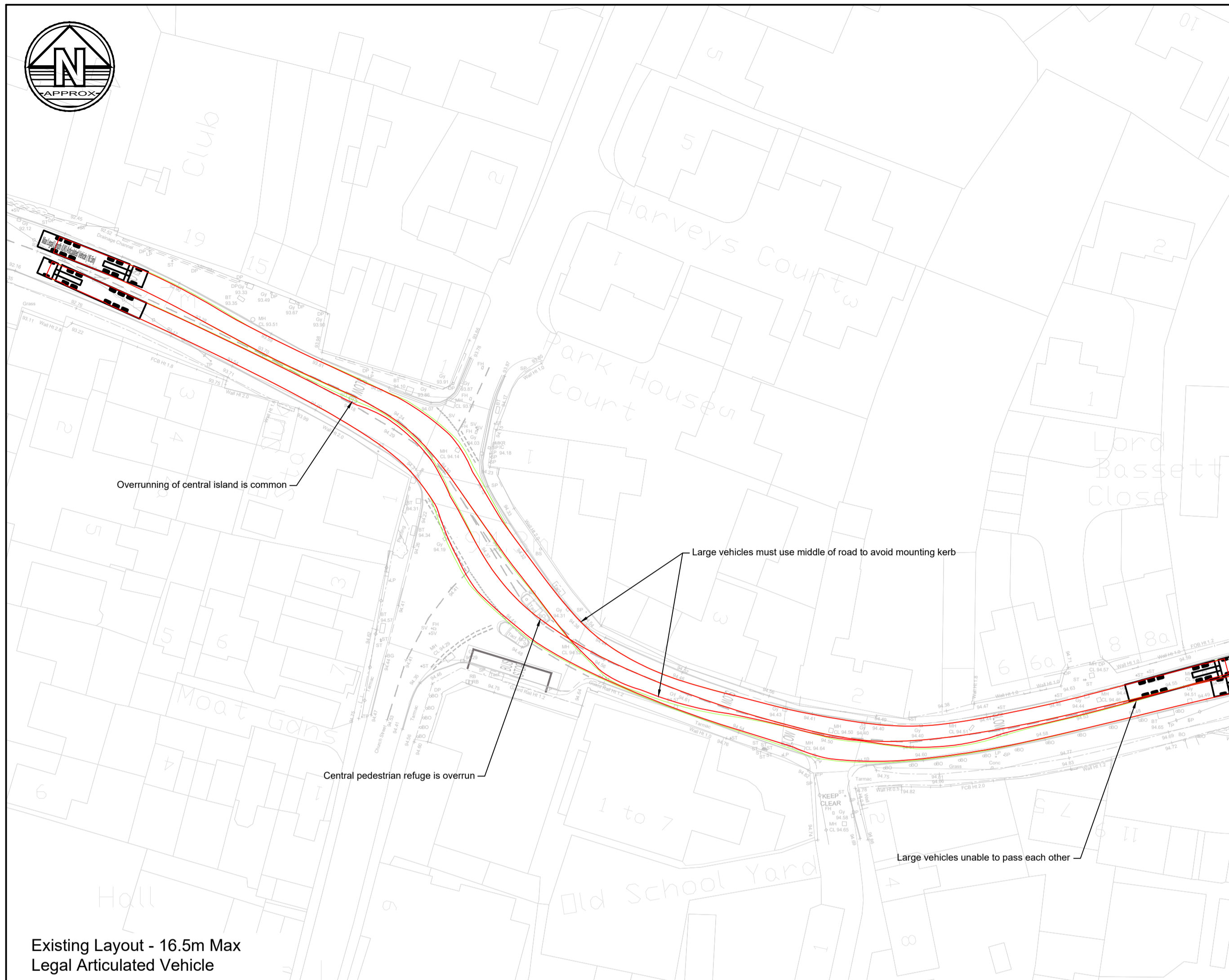

Existing Layout - 16.5m Max Legal Articulated Vehicle

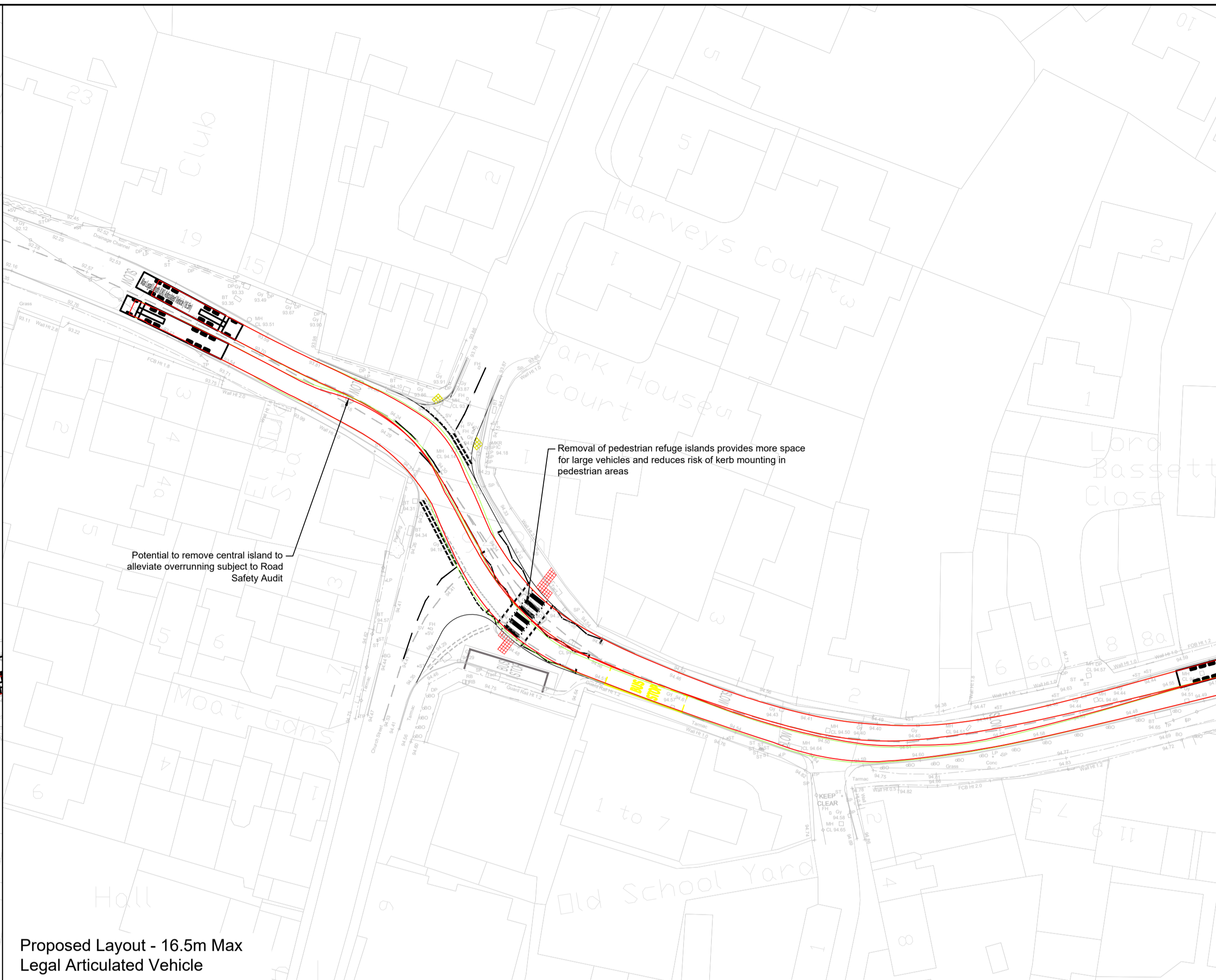

Proposed Layout - 16.5m Max Legal Articulated Vehicle

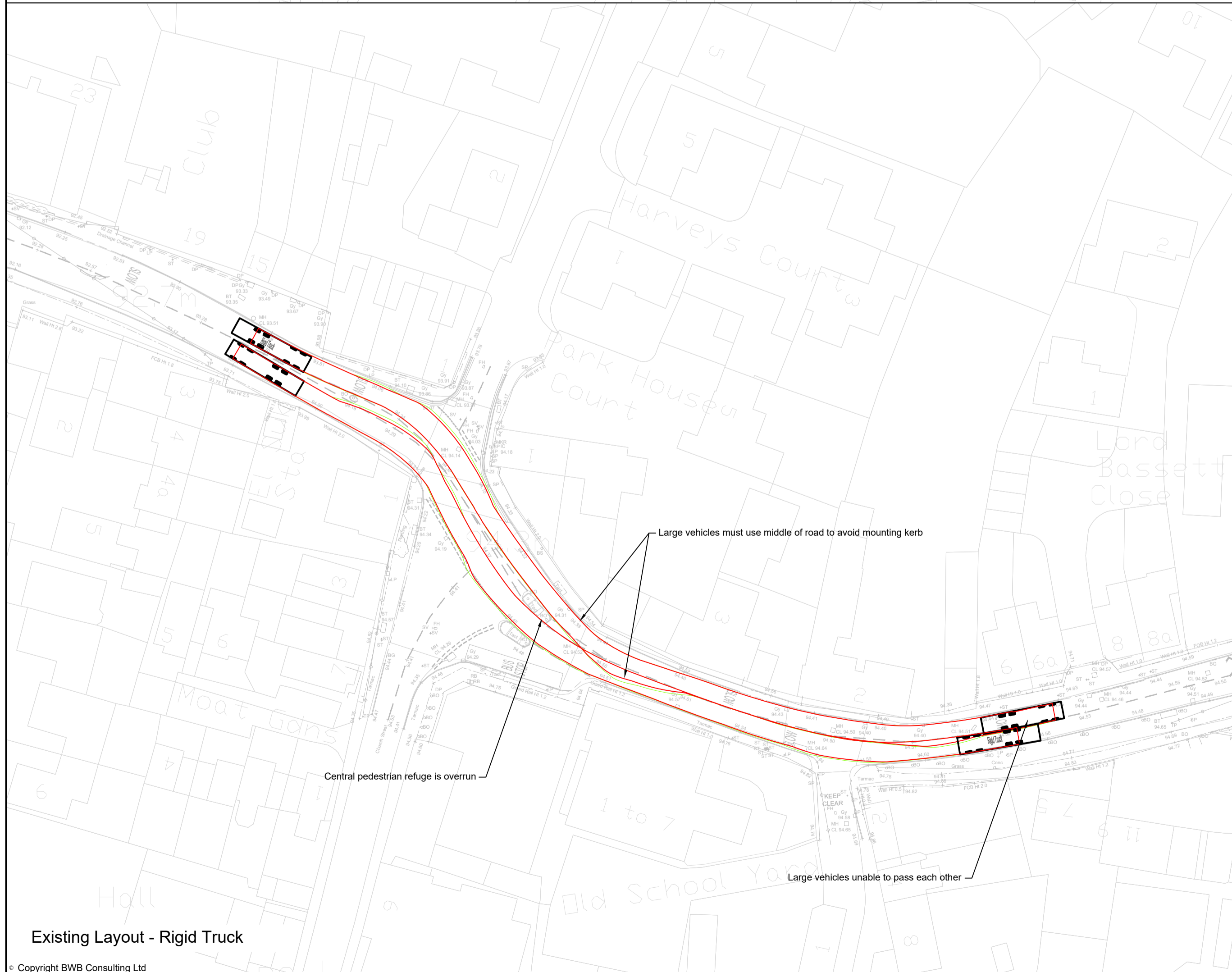

Existing Layout - Rigid Truck

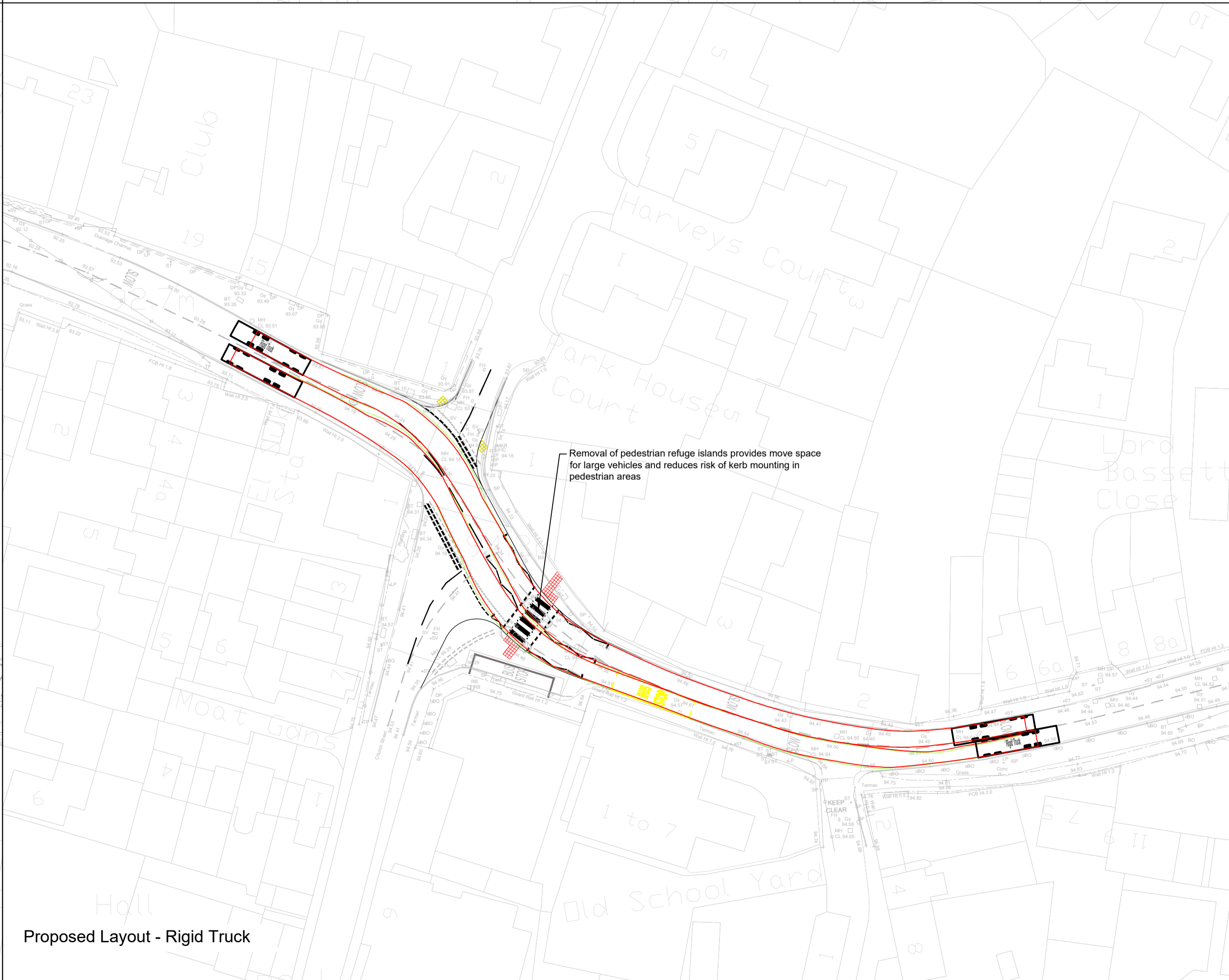

Proposed Layout - Rigid Truck

- Notes**
1. Do not scale this drawing. All dimensions must be checked/ verified on site. If in doubt ask.
 2. This drawing is to be read in conjunction with all relevant architects, engineers and specialists drawings and specifications.
 3. All dimensions in millimetres unless noted otherwise. All levels in metres unless noted otherwise.
 4. Any discrepancies noted on site are to be reported to the engineer immediately.

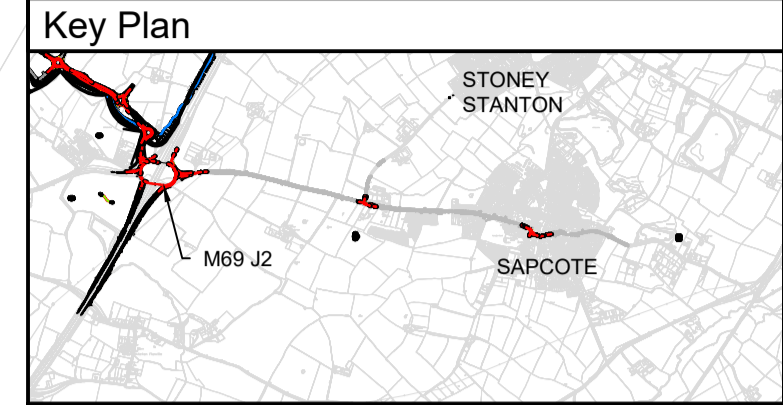

Legend

Max Legal Length (UK) Articulated Vehicle (16.5m)

Overall Length	16.500m
Overall Width	2.550m
Overall Body Height	3.681m
Min Body Ground Clearance	0.411m
Max Track Width	2.500m
Lock to lock time	6.00s
Kerb to Kerb Turning Radius	6.530m

Rigid Truck

Overall Length	12.000m
Overall Width	2.500m
Overall Body Height	3.328m
Min Body Ground Clearance	0.412m
Track Width	2.471m
Lock to lock time	6.00s
Kerb to Kerb Turning Radius	11.900m

PO2	04.01.24	Updated to suit revised layout	SC	SRH
P01	04.11.23	Preliminary Issue	JM	SC
Rev	Date	Details of issue / revision	Drw	Rev

Issues & Revisions

- Birmingham | 0121 233 3322
- Leeds | 0113 233 8000
- London | 020 7407 3879
- Manchester | 0161 233 4260
- Nottingham | 0115 924 1100

www.bwbconsulting.com

Client

Project Title
HINCKLEY NATIONAL RAIL FREIGHT INTERCHANGE

Drawing Title
SAPCOTE VEHICLE TRACKING SHEET 1

Drawn:	S Carter	Reviewed:	S Hilditch
BWB Ref:	NTT2814	Date:	04.11.23
Scale@A1:	1:500		
PRELIMINARY			
Project - Originator - Zone - Level - Type - Role - Number	Status	Rev	
HRF-BWB-GEN-XX-DR-TR-135	S2	P02	

Appendix A Part 3 - Vehicle Tracking Sheet 2

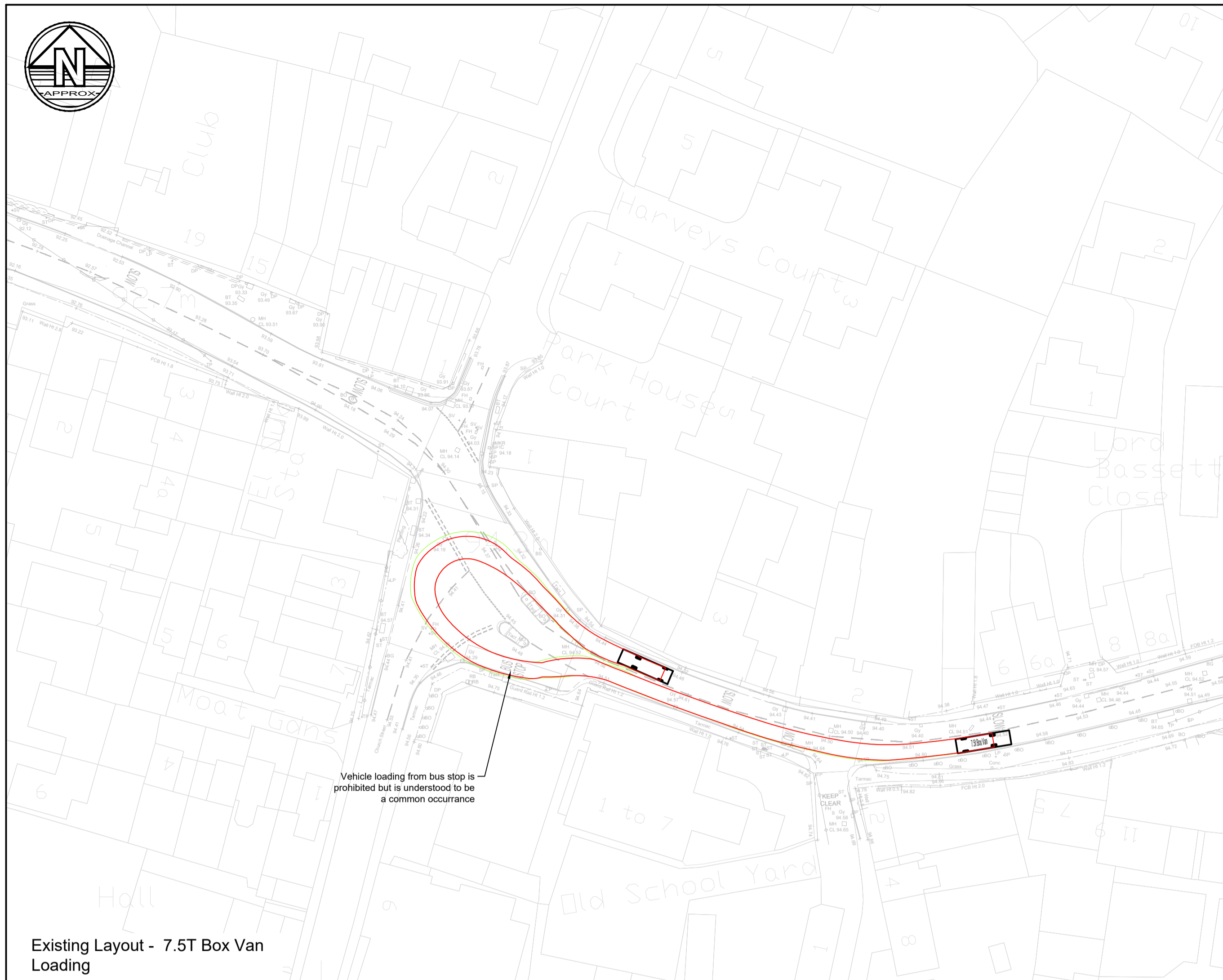

Existing Layout - 7.5T Box Van Loading



Proposed Layout - 7.5T Box Van Loading

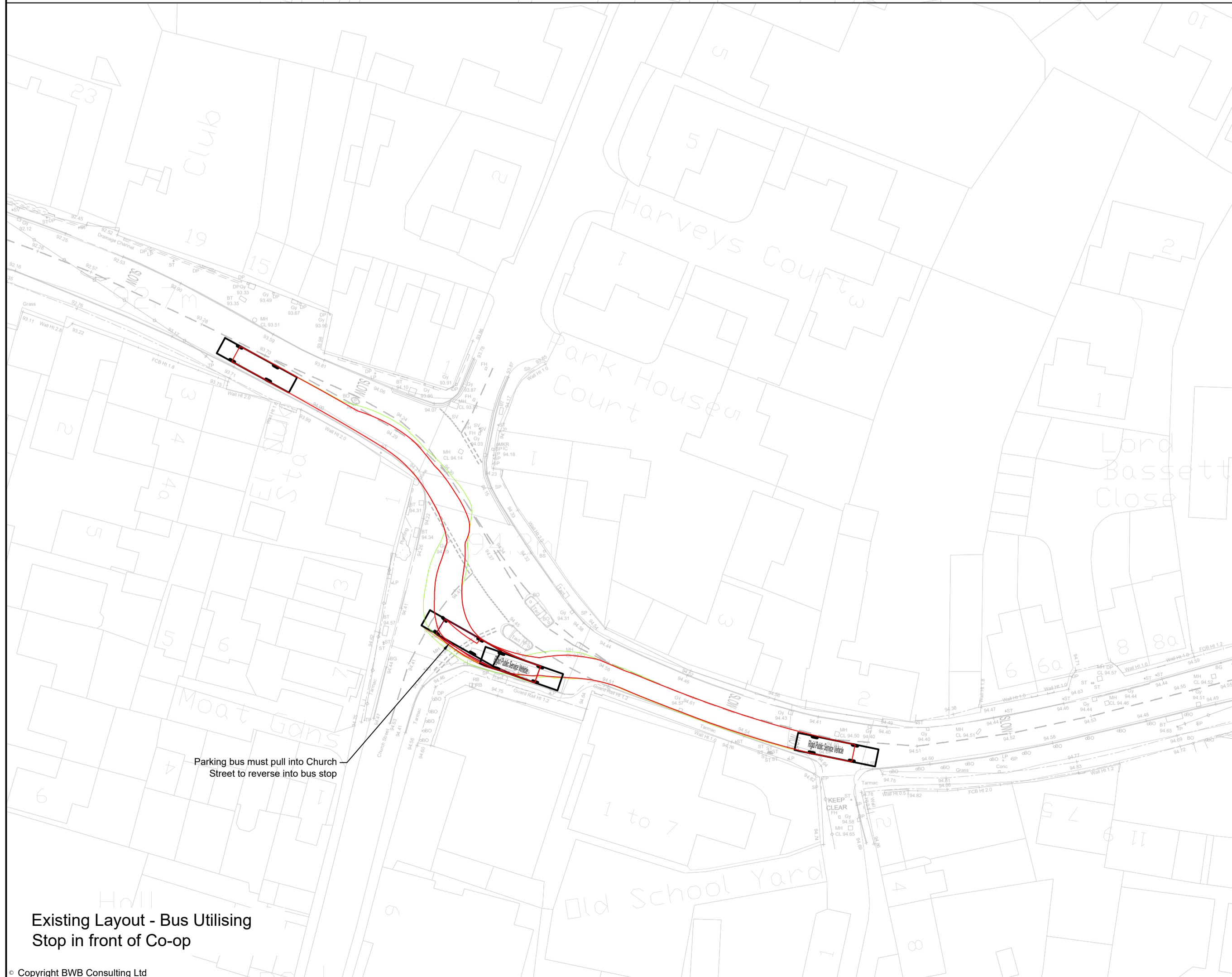

Existing Layout - Bus Utilising Stop in front of Co-op

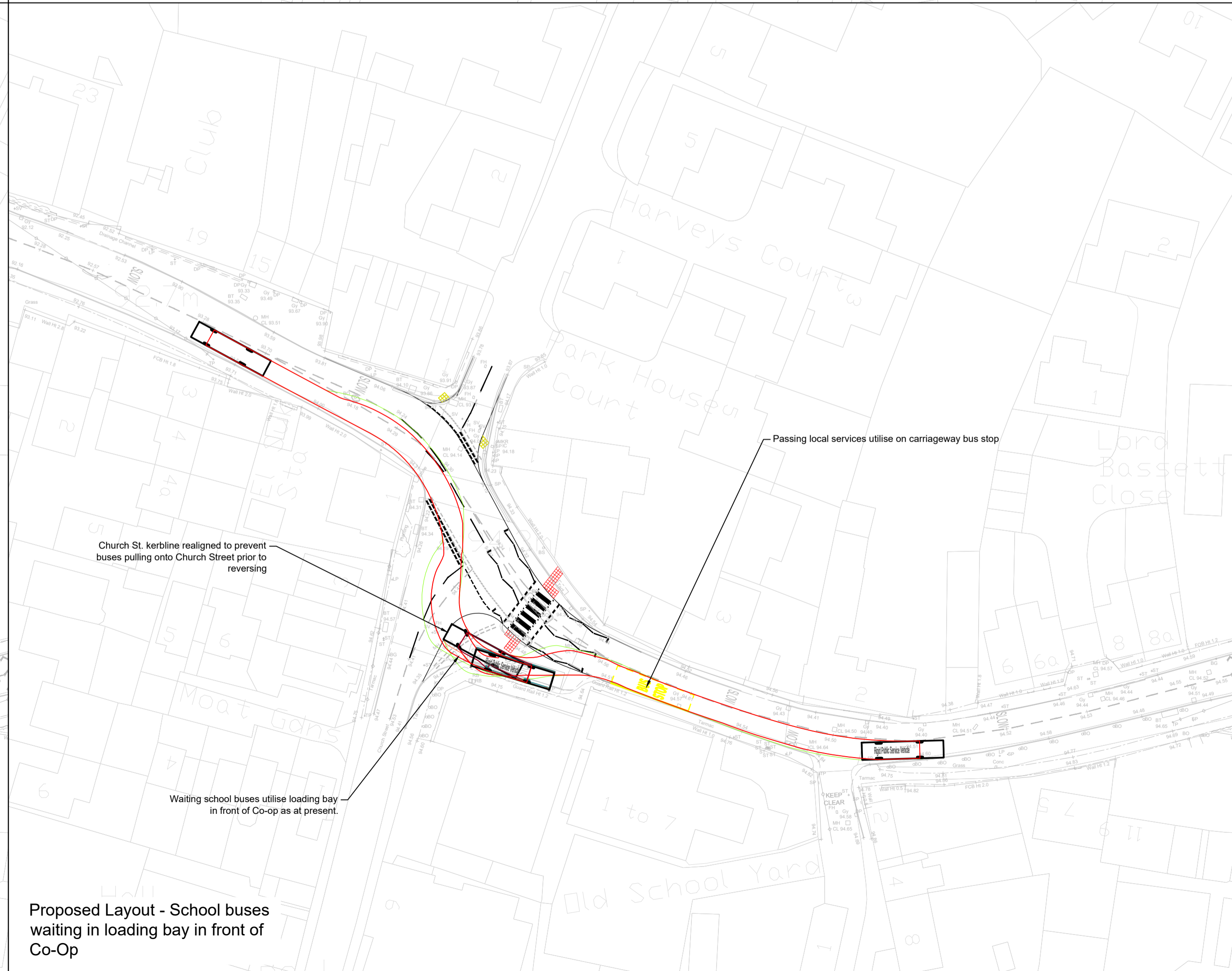

Proposed Layout - School buses waiting in loading bay in front of Co-Op

Notes

- Do not scale this drawing. All dimensions must be checked/ verified on site. If in doubt ask.
- This drawing is to be read in conjunction with all relevant architects, engineers and specialists drawings and specifications.
- All dimensions in millimetres unless noted otherwise. All levels in metres unless noted otherwise.
- Any discrepancies noted on site are to be reported to the engineer immediately.

Key Plan

Legend

	8.010m
Overall Length	2.100m
Overall Width	3.356m
Overall Body Height	0.351m
Min Body Ground Clearance	2.064m
Track Width	4.00m
Lock to lock time	7.400m
Kerb to Kerb Turning Radius	

	12.000m
Overall Length	2.550m
Overall Width	4.173m
Overall Body Height	0.344m
Min Body Ground Clearance	2.550m
Track Width	4.00m
Lock to lock time	10.500m
Kerb to Kerb Turning Radius	

P01	04.01.24	Preliminary Issue	SC	SRH
Rev	Date	Details of issue / revision	Drw	Rev

Issues & Revisions

BWB
A CAF GROUP COMPANY

- Birmingham | 0121 233 3322
- Leeds | 0113 233 8000
- London | 020 7407 3879
- Manchester | 0161 233 4260
- Nottingham | 0115 924 1100
- www.bwbconsulting.com

Client

TRITAX SYMMETRY
A TRITAX BIG BOX COMPANY

Project Title

HINCKLEY NATIONAL RAIL FREIGHT INTERCHANGE

Drawing Title

SAPCOTE VEHICLE TRACKING SHEET 2

Drawn:	S Carter	Reviewed:	S Hilditch
BWB Ref:	ntt2814	Date:	04.01.24
Scale@A1:	1:500		

Drawing Status

PRELIMINARY

Project - Originator - Zone - Level - Type - Role - Number	Status	Rev
HRF-BWB-GEN-XX-DR-TR-136	S2	P01

Copyright BWB Consulting Ltd

X:\NTT\NTT2814_Hinckley Rail Freight Interchange\02_Project Delivery\01_WIP\Drawings\Other drawings\HRF-BWB-GEN-XX-DR-TR-136 - Sapcote Swept paths.dwg

Appendix A Part 4 - Vehicle Tracking Sheet 3

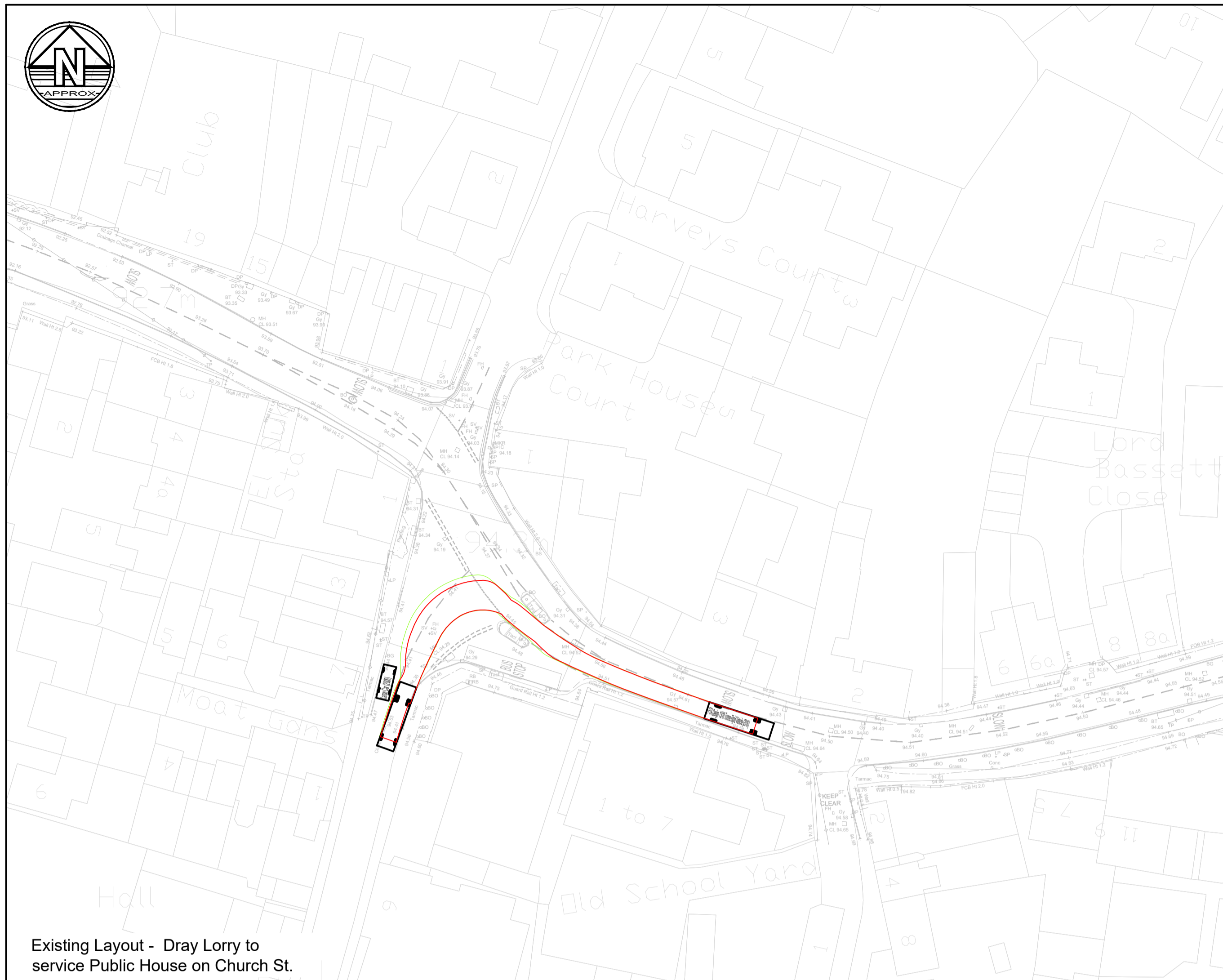

Existing Layout - Dray Lorry to service Public House on Church St.

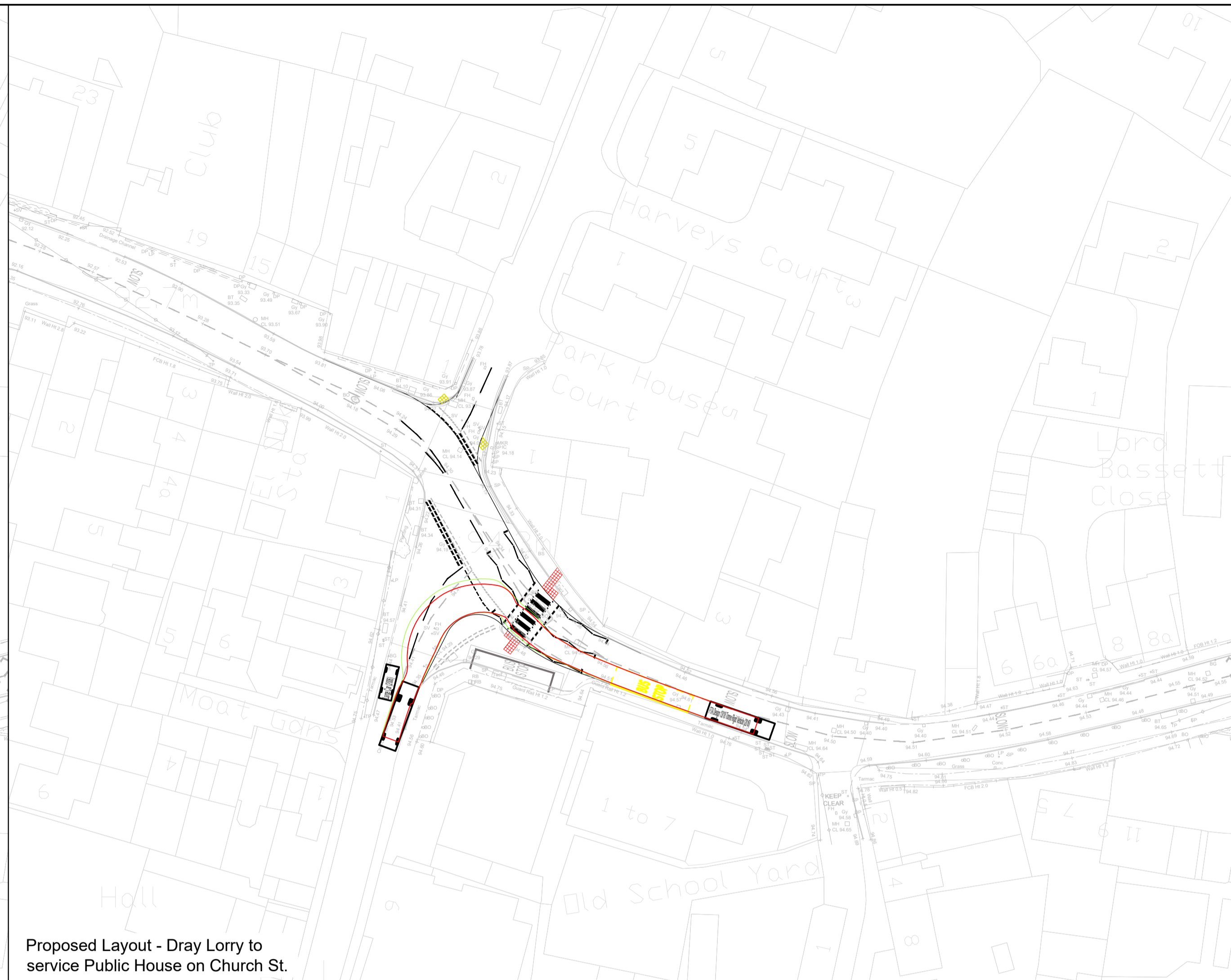

Proposed Layout - Dray Lorry to service Public House on Church St.

- Notes**
1. Do not scale this drawing. All dimensions must be checked/ verified on site. If in doubt ask.
 2. This drawing is to be read in conjunction with all relevant architects, engineers and specialists drawings and specifications.
 3. All dimensions in millimetres unless noted otherwise. All levels in metres unless noted otherwise.
 4. Any discrepancies noted on site are to be reported to the engineer immediately.

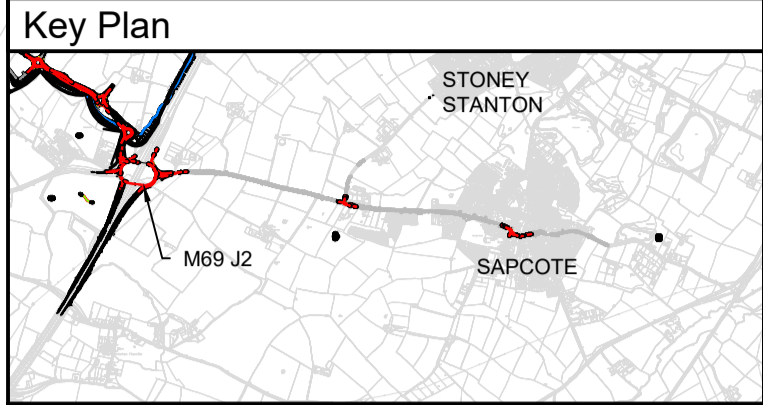

Legend

FTA Design 13/18 Tonne Rigid Vehicle (2016)

Overall Length	10.000m
Overall Width	2.550m
Overall Body Height	3.845m
Min Body Ground Clearance	0.440m
Track Width	2.470m
Lock to lock time	3.00s
Kerb to Kerb Turning Radius	11.000m

P01	04.01.24	Preliminary Issue	SC	SRH
Rev	Date	Details of issue / revision	Dw	Rev

Issues & Revisions

BWB
A CAF GROUP COMPANY

- Birmingham | 0121 233 3322
- Leeds | 0113 233 8000
- London | 020 7407 3879
- Manchester | 0161 233 4260
- Nottingham | 0115 924 1100

www.bwbconsulting.com

Client

TRITAX SYMMETRY
A TRITAX BIG BOX COMPANY

Project Title

HINCKLEY NATIONAL RAIL FREIGHT INTERCHANGE

Drawing Title

SAPCOTE VEHICLE TRACKING SHEET 3

Drawn:	S Carter	Reviewed:	S Hilditch
BWB Ref:	ntt2814	Date:	04.01.24
Scale@A1:	1:500		

Drawing Status

PRELIMINARY

Project - Originator - Zone - Level - Type - Role - Number	Status	Rev
HRF-BWB-GEN-XX-DR-TR-137	S2	P01